

STEDER I

LANDSKABET

## *Place matters – Places in landscapes*

Annemarie Lund  
Nordens Hus, Reykjavík  
7. juni 2013

*Places in Landscapes* is part of the campaign *Place matters*. To introduce the campaign *Places in landscapes* Realdania published a small booklet to give inspiration and show examples, both from Denmark but also from other countries such as Spain, The Netherlands, Switzerland, Chile, USA, China and of course Norway. Seven specialists were asked to reflect on and write about pros and cons for installations in vulnerable, often protected landscapes [www.stedet-taeller.dk](http://www.stedet-taeller.dk)

Kongenshus Memorial Park, 1945-1953, was laid out as a monument to those who reclaimed the heaths for agriculture. After trekking through the area C.Th. Sørensen chose an valley that winds through the heath, with softly rounded slopes.

Landscape architect: C.Th. Sørensen. Architect: Hans Georg Skovgaard

Drawing: Danish National Art Library, Architectural Drawings Collection

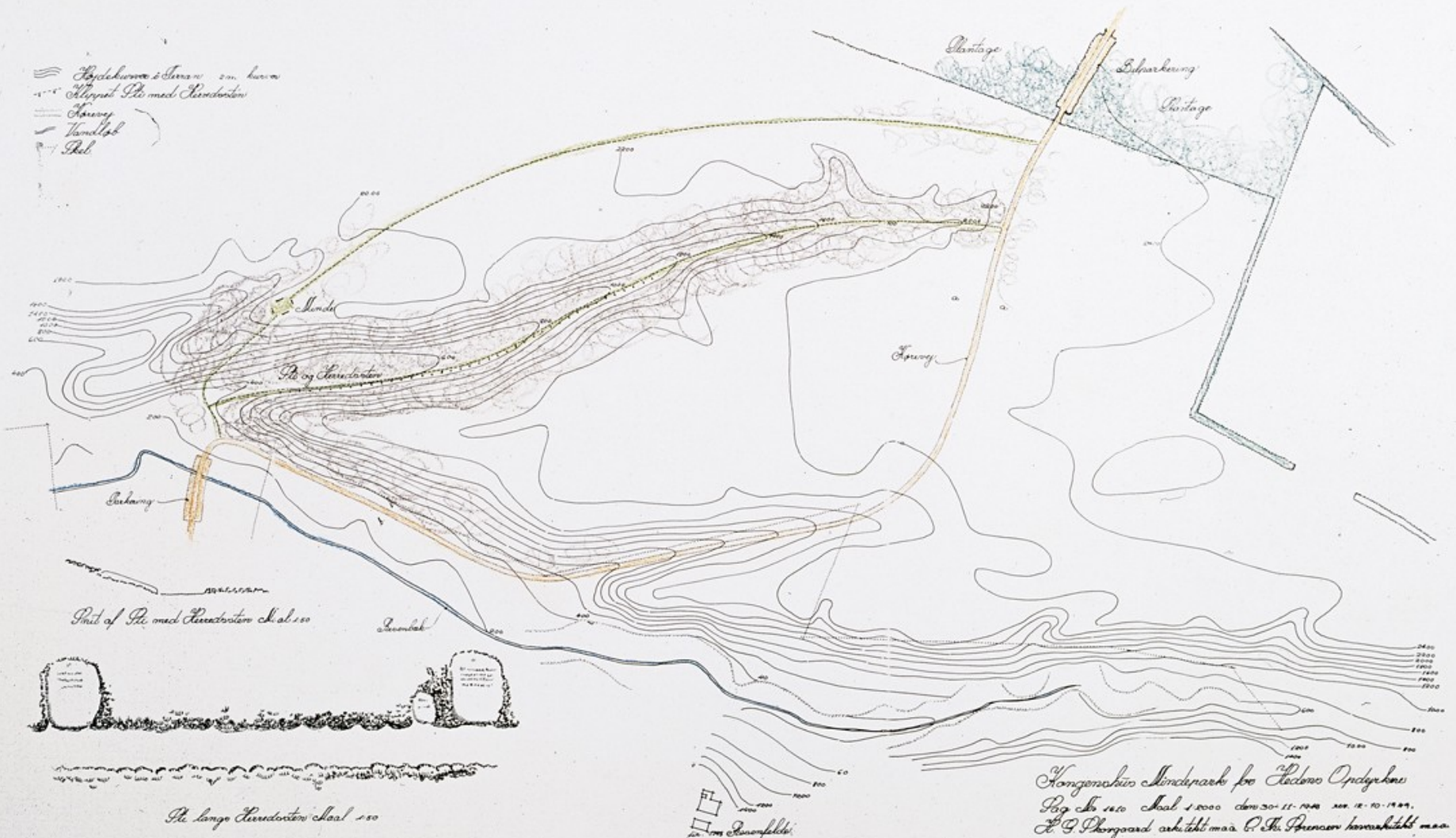

C.Th. Sørensen created a powerful, sublime landscape sculpture in which the visitor walks along a line, originally a narrow path trod in the grass, ending in a round meeting place. The path is accentuated by boulders standing at 20-meter intervals, each representing one parish, with the names of those who helped reclaim the heath. Hans Georg Skovgaard designed the motifs and the inscriptions for all 39 stones



Memorial grove for fishermen lost at sea.  
1949  
Hjertingvej, Esbjerg  
Landscape architect: C.Th. Sørensen  
Artist: August Keil

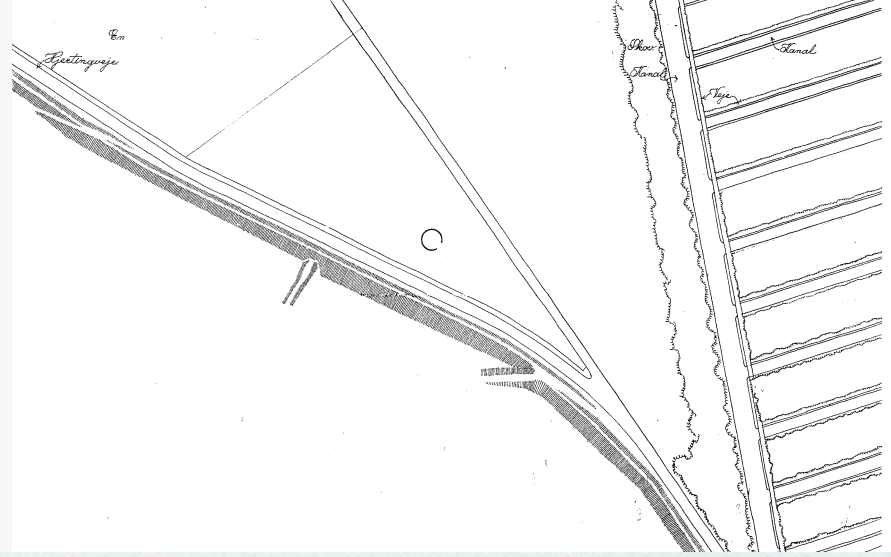

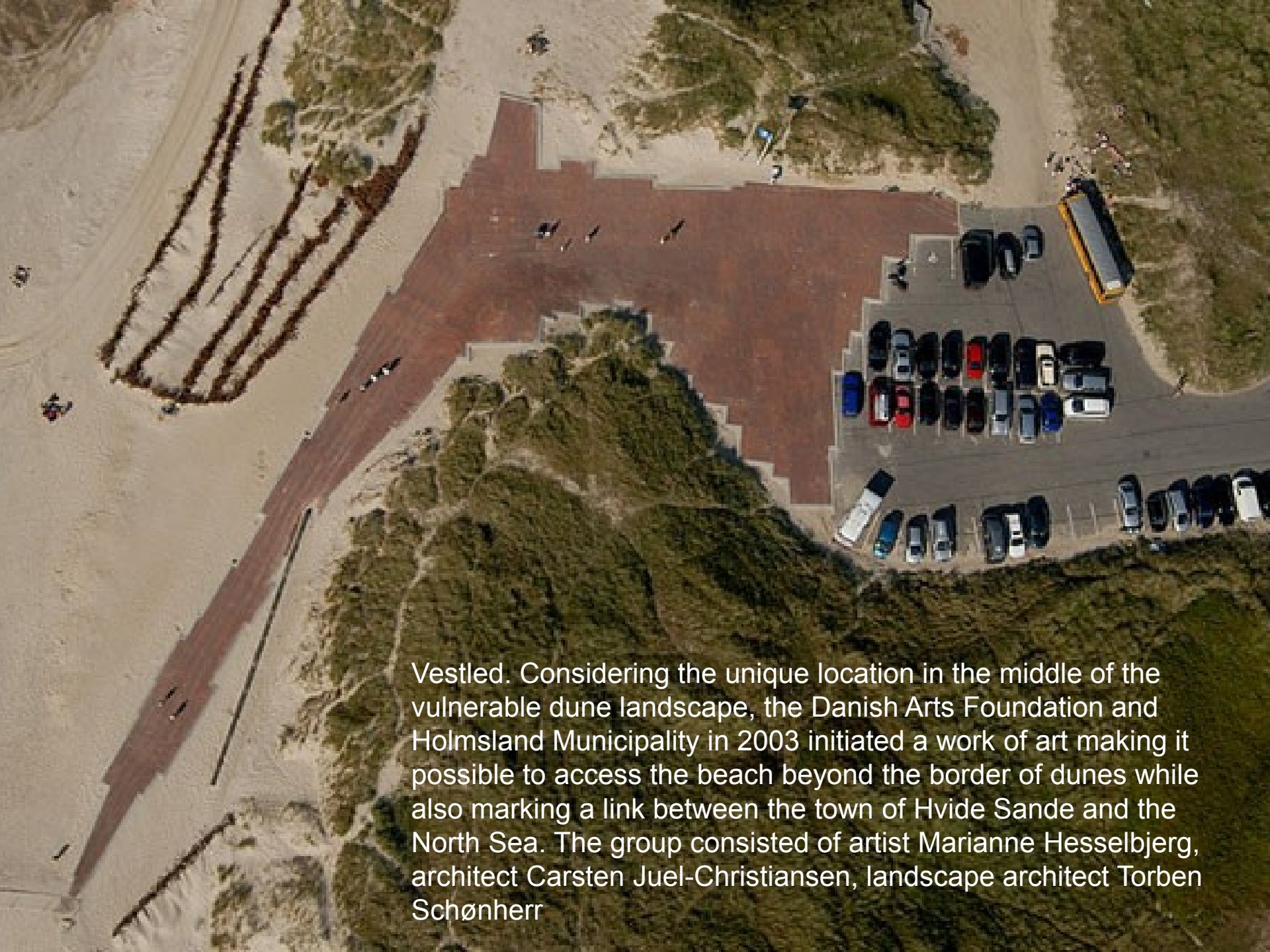

Vestled. Considering the unique location in the middle of the vulnerable dune landscape, the Danish Arts Foundation and Holmsland Municipality in 2003 initiated a work of art making it possible to access the beach beyond the border of dunes while also marking a link between the town of Hvide Sande and the North Sea. The group consisted of artist Marianne Hesselbjerg, architect Carsten Juel-Christiansen, landscape architect Torben Schønherr



The main elements are a tile covered land sculpture laid across the dunes like a saddle and a 28 metre long horizontal bronze sculpture pointing towards the horizon





- Råbjerg Mose: Primus Arkitekter with Schul Landskabsarkitekter
- Rubjerg Knude: Powerhouse Company with JAJA Architects

• Hanstedreservatet, Rørbæk og Møller Arkitekter with Anders Abraham + Steen Høyer

• Klinteknuden, Fur: Leth & Gori with Reiulf Ramstad Arkitekter

• Kalø Slotsruin: MAP Architects & MAST-Studio with Marco Mercuri

• Tipperne: Bertelsen & Scheving Arkitekter, Christoffer Thorborg + Sebastian Skovsted + Søren Johansen

• Filsø: Schönherr with Cubo Arkitekter

Hammersholm: Erik Brandt Dam Arkitekter  
• Stevns Klint: Juul Frost Arkitekter

• Ballum Sluse: Oooja Architects with Kimthorsell Architects



1. At the outlet of Brede Creek in Southern Jutland, Ballum Lock controls the flow of water through the dikes. From the top of the dike there is a view of the tidflats on one side and the soft green meadows and the dammed-up creek on the other. Twice a year, flocks of starlings gather and can be seen to block the sunlight, creating complex patterns in the sky; the phenomenon is known as 'sort sol' – black sun. Ballum Lock is an example of a beautiful Danish natural resort where *accessibility and opportunities for visiting and viewing* do not match.

Oooja Architects, Kimthorsell Architects





2. Filsø, once Denmark's second largest lake will be restored to 915 ha, with small islands for birds and wildlife. New *arrival facilities* and *viewpoints* for the visitors.  
Schönherr, Cubo Arkitekter, Grontmij

3. Tipperne, international important sanctuary for birds, special flora and fauna.

*Arrival facilities and a path system.*

Bertelsen & Scheving Arkitekter: Christoffer Thorborg, Sebastian Skovsted, Søren Johansen



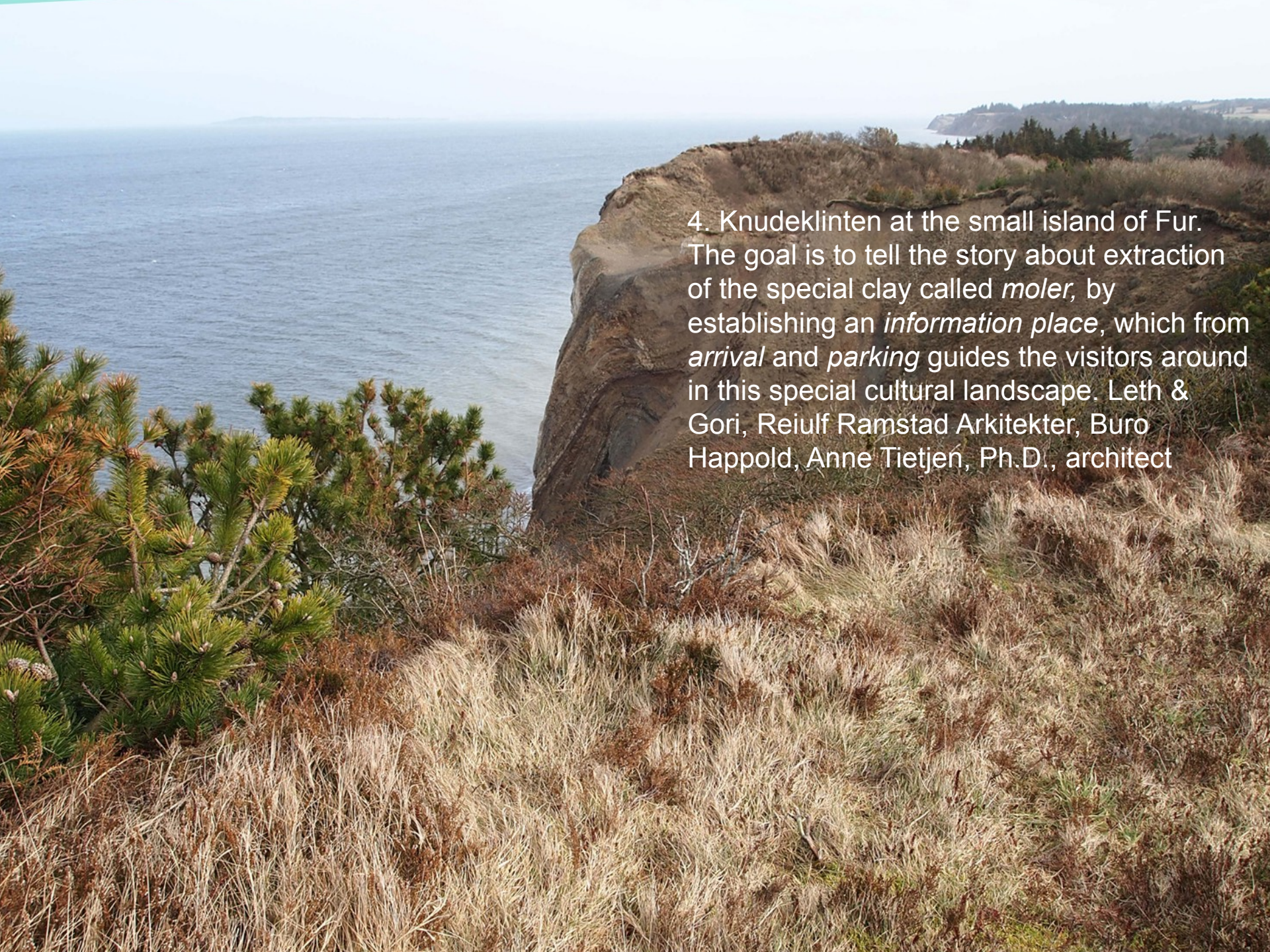

4. Knudeklinten at the small island of Fur. The goal is to tell the story about extraction of the special clay called *moler*, by establishing an *information place*, which from *arrival* and *parking* guides the visitors around in this special cultural landscape. Leth & Gori, Reiulf Ramstad Arkitekter, Buro Happold, Anne Tietjen, Ph.D., architect

5. Hansted wild life reserve in Thy National Park, 40 square kilometer. The number of visitors has increased, the project will include *arrival facilities*, several *view points*, and a *path system*.  
Rørbæk and Møller Arkitekter, Anders Abraham, Steen Høyer



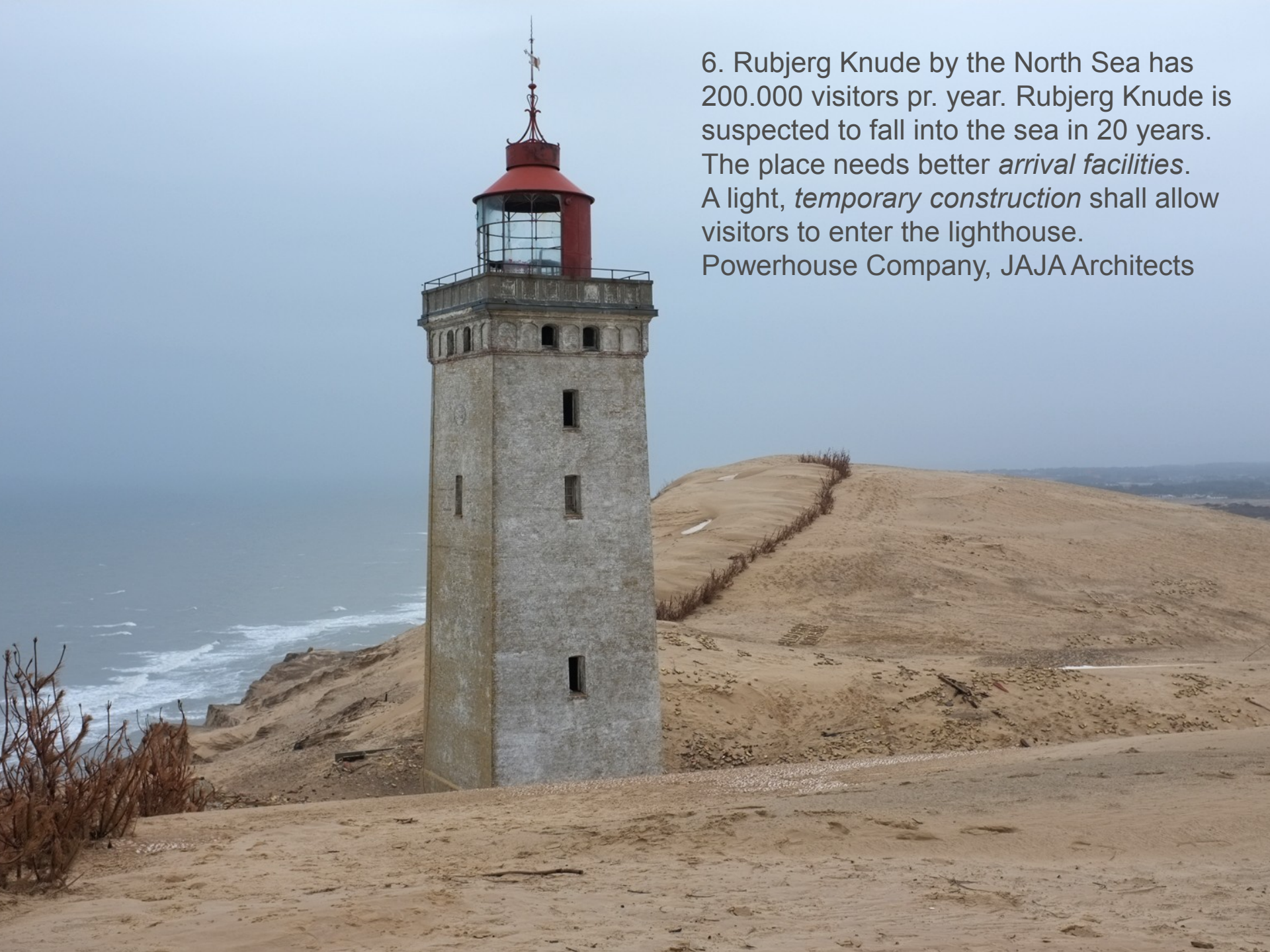

6. Rubjerg Knude by the North Sea has 200.000 visitors pr. year. Rubjerg Knude is suspected to fall into the sea in 20 years. The place needs better *arrival facilities*. A light, *temporary construction* shall allow visitors to enter the lighthouse.  
Powerhouse Company, JAJA Architects

7. At the ruin of Kalø Castle in Eastern Jutland the entire location shall show the magic of the building and its surroundings. Establishment of facilities that enable visitors to enjoy the *view from the top* of the ruins, as well as enhancement of the *visitor's facilities*.  
MAP Architects & MAST-Studio with Marco Mercuri





8. Stevns Lighthouse at Stevns Klint, candidate to UNESCO's world heritage list 2010.  
*Visitor's facilities.* Juul Frost Arkitekter, Niras, Niku



9. At Råbjerg Marsh in Northern Jutland the almost untouched landscape will be enriched with *arrival facilities* and *paths*. The *new pathways* are meant to emphasize the poetic character of the landscape, guide the movement of visitors and protect the fragile marsh.  
Primus Arkitekter, Schul Landskabsarkitekter, Rambøll



# Koncept

## Concept – Råbjerg Marsh

The existing typology of the marsh is used, and a system of short cuts will be established to create possibilities for the visitor to choose his own way.

March 2013. Primus Arkitekter ApS,  
Schul Landskabsarkitekter ApS, Rambøll A/S

Hovedgrebet for at skabe adgang til området består i at udnytte den eksisterende typologi og indføre en række kortslutninger. Herved dannes en række forbindelser der giver adgang og lader den besøgende finde sine egne ruter

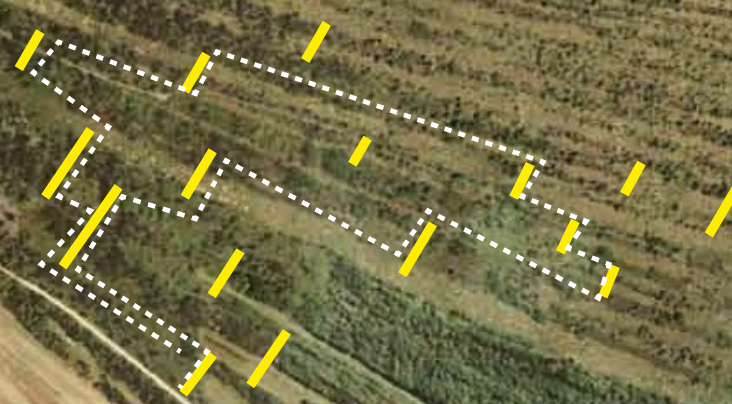

# Forbindelsen som pontoner

Stålkassetter monteret som pontoner kan udformes med flydende egenskaber og fyldt med fast skum sikres en opdrift, der giver mulighed for at reducere behovet for fundering. Endvidere vil denne anlægsteknik kunne skabe en konstant tæt kontakt til vandet og i lange perioder fremstå med fugtig, reflekterende overflade og her spejle himlen samt syne tydeligt på lang afstand.

March 2013. Primus Arkitekter ApS,  
**Schul Landskabsarkitekter ApS, Rambøll A/S**

10. The cliffs of Bornholm are unique in Denmark and attract many visitors. At Hammersholm new *paths*, *signage*, and one or more *architectural initiatives* will invite exploration of Denmark's largest cluster of rock carvings. Erik Brandt Dam Arkitekter



# Hammersholm, Bornholm

**ERIK  
BRANDT  
DAM  
ARKITEKTER**

- STANG
- GRÅVOLDSTEIN
- BRØ
- SKÆRVEJLICH
- FRITSTÅENDE TRÆ
- HELLERSTING
- GRAVHJUL
- VANDTUL
- TIDIGERE BRUG
- RYDNING AF GRÆS
- GRØFT
- STEVTE

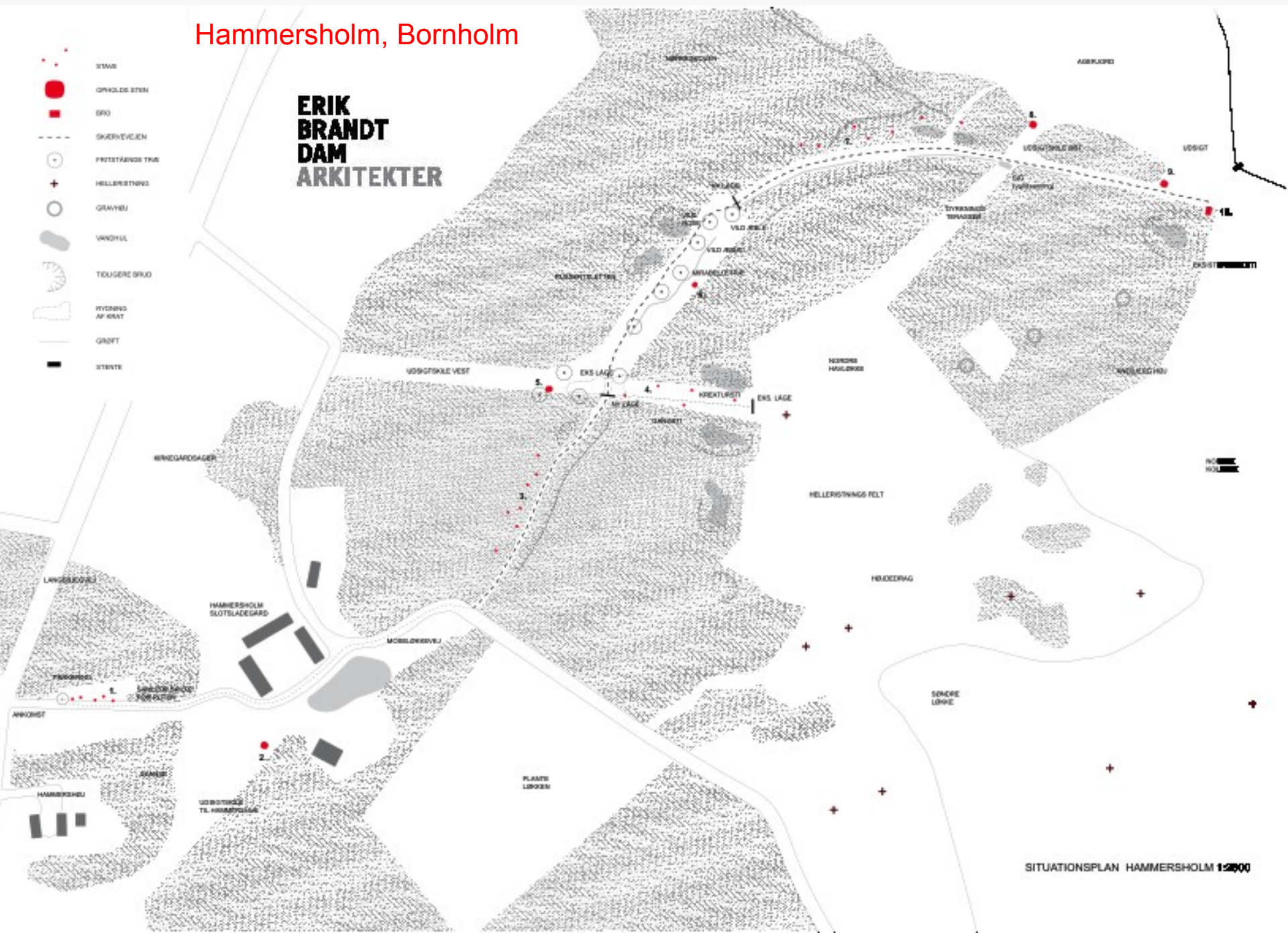



ARKITECTURBILAG

**ERIK  
BRANDT  
DAM  
ARKITEKTER**



**ANKOMST, PARKERING OG BILKLING**

Farkellet udspringer fra parkeringspladsen ved Landetorvet. Her sættes scenen den begrænsede til parkeringspladsen af en gruppe af træer, der er et eksempel på hellebærende træer. Udførelsen af træerne er i henhold til deres højde og runde tykkelser, der er karakteristiske for Landetorvet.

Siden der i dag udfører parkeringsområdet fra Mønstervangens Gade og området af træer. Disse træer vil blive erstattet med parkeringspladsen. For at sikre en fremtidig information om træer, der er karakteristiske for området, er det nødvendigt at sikre, at disse træer bliver det dominerende i området. Hvert træ vil blive erstattet med en anden trætype.

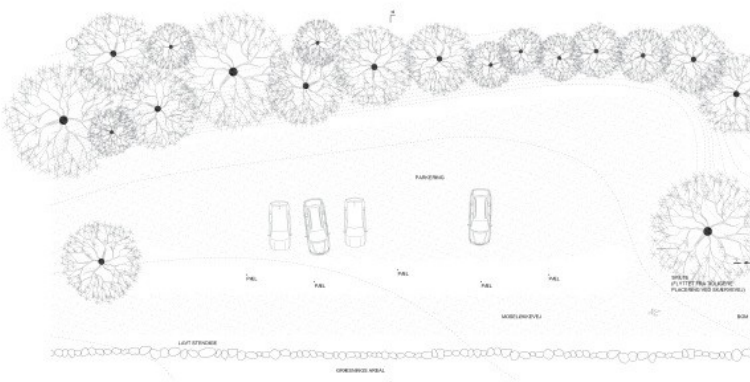

PLAN 1:200



SNIT AA 1:200

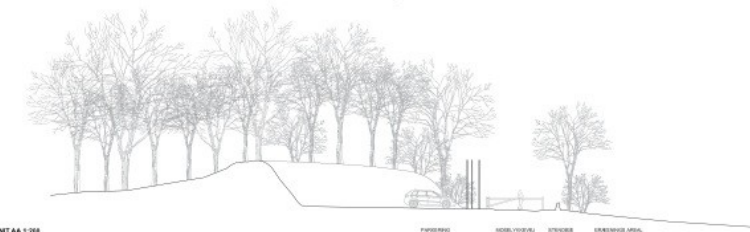

SNIT AA 1:200



**Hammersholm, Bornholm**

**LYENING LANDS SKURVEVEJEN**

Large skurevejens vejde side ligger mellem to tidligere store grundkøber, som træer af den udførte side. De vil være indstillet side af træerne og i et område.

Landsvejens er et mindre skurevejens har en gruppe af træer, der er indstillet med mellem træerne og side af træerne vil de skurevejens side af træerne.

Siden der vil være et område, der vil være indstillet med mellem træerne og side af træerne vil de skurevejens side af træerne.

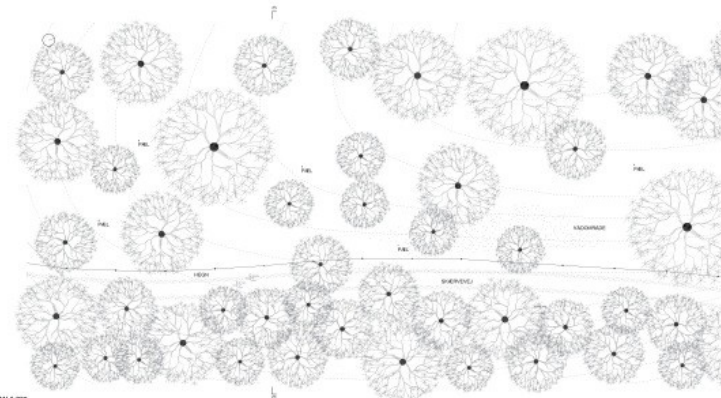

PLAN 1:200





OPHOLD I HAMMERSHOLM PÅRULDS

**ERIK  
BRANDT  
DAM  
ARKITEKTER**

**NEDSLAG 2**

Årsberetning for den planlagte åbning af Hammersholm Skovstige. Det foreslås planlagt en række træer og den tidligere skov, kaldet Hammersholm Skovstige og Hammersholm Skov, og gøre den tilgængelig for offentlige gæster og dermed forstærke forbindelsen mellem området og byen.

Forslaget er et udvalgt område i den tidligere skovstige. Hver trætype i skovet er på gælden. Fra skoven vil der være udsigt af byen og medtaget forskudt med åbne udsigt til Hammersholm.

Skovens skovstige er planlagt at være en medtaget forskudt med åbne udsigt til den skovstige skov.

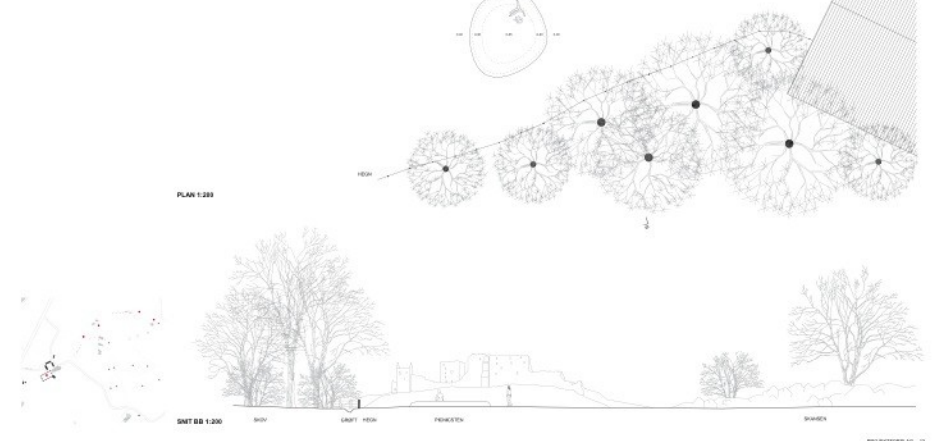

PROJEKTLÆG 13

**Hammersholm, Bornholm**



**NEDSLAG 10**  
**BRØD VED SKARVEVEJENS AFSLUTNING**

Ved skovstignens afslutning og brydning af Årsberetningens skovstige er der et område af den skovstignende træer. Det nye træ vil med et forslag og en udsigt til skovstignen med skovstignen og træerne til at skovstignen i området skovstignen.

Det skovstignende skov vil træer, ønsket skovstignen i skovstignen med skovstignen.

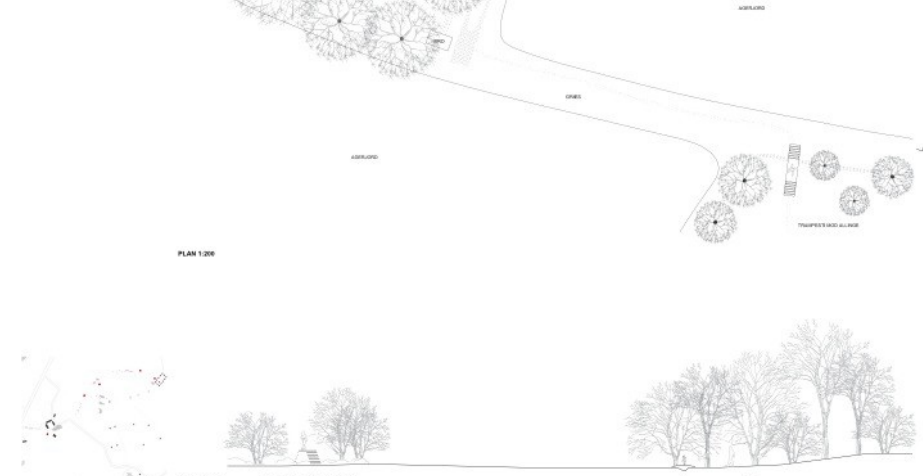

PROJEKTLÆG 13

The star-path project for Vestre Cemetery, 1998-2001

The South Chapel lost its original function and has been transformed into an open structure, a kind of pavillon. Which lies in the center of two crossing axes with cherry trees. The area is separated from the surrounding cemetery by four large iron gates

Landscape architect: Schønherr





The star-path project for Vestre Cemetery  
Landscape architect: Schönherr



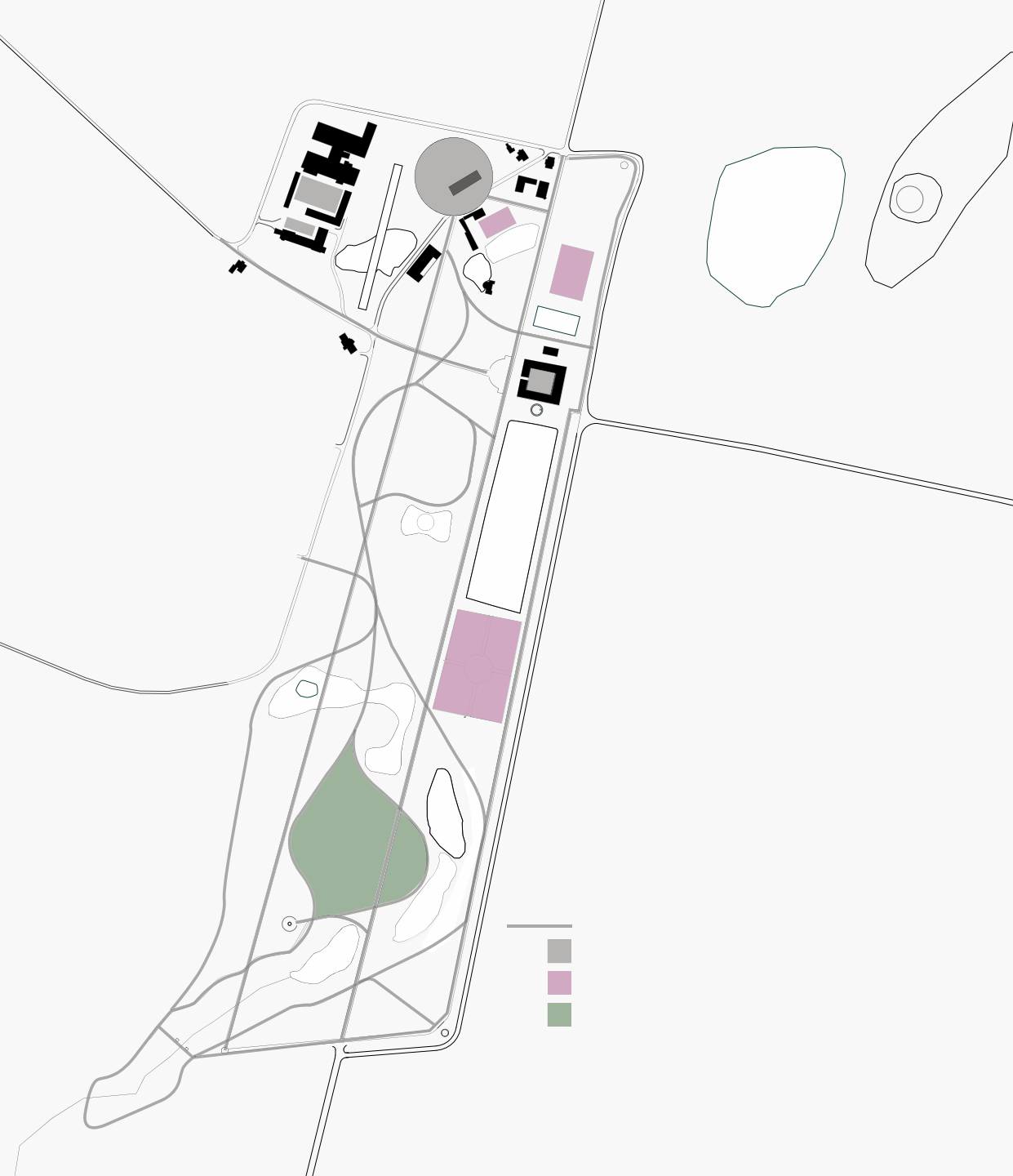

Glorup Manor garden,  
2011-13  
Diagram of new layers of  
treated surfaces: paths,  
gardens,  
  
Absolut Landskab in  
collaboration with MIST

# Glorup Gods - new public acces to historical park and garden (DK)

project phase: masterplan, landscape project 1st phase:  
new access, parking and stairs,  
festival of contemporary art summer 2013

client: Jacob Moltke-Huitfeldt Rosenkrantz

site: Svindinge, Fyn, Denmark

year / status: 2009 (masterplan) -  
2013 (1st phase inagurated May 2013)

area: 800 m new path, parking and arrival 500 m2,  
stair and bridge 150 m2

budget: 2.5 mio kr / 340.000 euro

project group: ABSOLUT landskab, grassat+MIST landskab,  
pHD Rikke Stenbro, pHD Liv Oustrup, artist Karin Lorentzen

AB  
SO  
LUTLA  
NDS  
KAB

grassat  
+  
MIST



# Glorup Gods - new public acces to historical park and garden (DK) - program

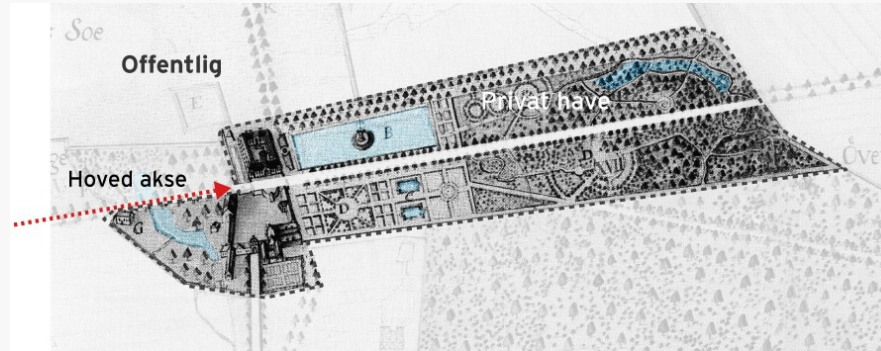

1776 plan by N.H. Jardin - private estate + main axis

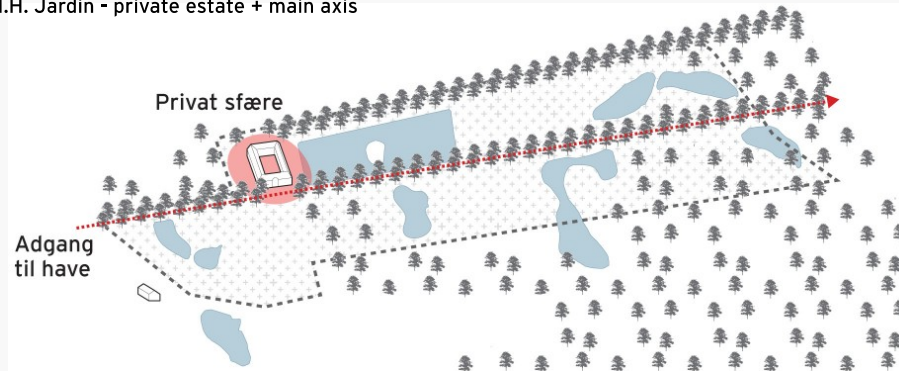

2011 - conflict between private area and public acces in main axis

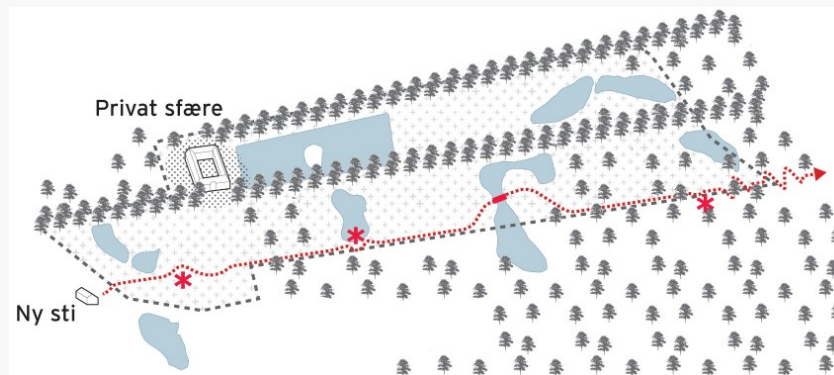

2012 - new public acces - using the 3rd axis from the plan by Jardin, adapting to existing landscape

# Glorup Gods - new public acces to historical park and garden - concept and working methods - from model work to field work

AB  
SO  
LUTLA  
NDS  
KAB  
grassat  
+  
MIST

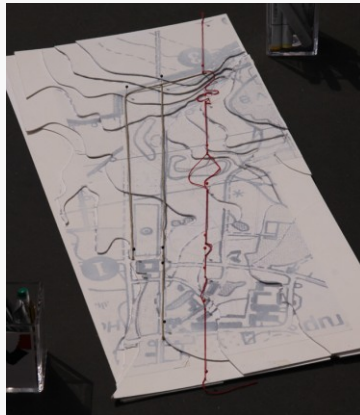
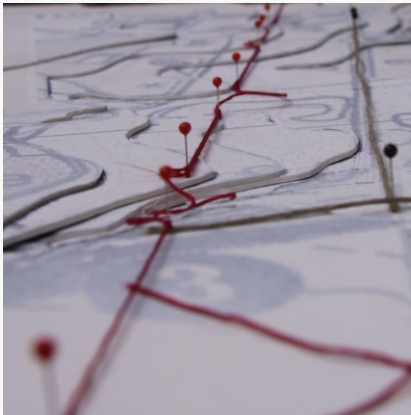

# Glorup Gods - new public acces to historical park and garden - arrival and parking

AB  
SO  
LUTLA  
NDS  
KAB  
grassat  
+  
MIST



# Glorup Gods - new public acces to historical park and garden - new garden path

AB  
SO  
LUTLA  
NDS  
KAB  
grassat  
+  
MIST



# Glorup Gods - new public acces to historical park and garden - stairs and bridge

AB  
SO  
LUTLA  
NDS  
KAB  
grassat  
+  
MIST

